

## 229CTRW3.5 Straight Angle Rectangular Waveguide to Coaxial Adapter 3,3 – 4.9 GHz WR229 to 3.5mm Female

### Attributes

#### Electrical Specification

Adapter Type	Right Angel
Adapter Grade	Standard
Frequency Band	Ku
Waveguide Type	Rectangular
Waveguide Size EI WR	WR229
Min. Frequency (GHz)	3.3
Max. Frequency (GHz)	4.9
VSWR Max	1.3
VSWR Min	1
Impedance ( $\Omega$ )	50
Max. Insertion Loss (dB)	0.25
Min. Insertion Loss (dB)	0.22

#### Interface

Flange Style	Square
Connector	3.5 mm
Connector Type	Female

#### Mechanical Specification

Body Material	Al
Finishing	Gray Paint
Operating Temp Low( $^{\circ}$ c)	-50
Operating Temp High( $^{\circ}$ c)	80



**Overview**

**Right angle rectangular waveguide to coaxial adapter 229CTRW3.5, operating from 3.3 to 4.9 GHz with a 0.25dB insertion loss and low VSWR 1.25:1. 229CTRW3.5 can be an efficient transition between the rectangular waveguide WR229 and coaxial 3.5 female connector. It can handle 50W continuously and 3KW peak power. The flange of waveguide WR229 is FDP40 (UDR40). These waveguide to coaxial adapters is consistent with the CACIRA standard of high quality and are indispensable components in any microwave project, such as microwave testing, and systems.**

## Results (Back to-Back Connection)

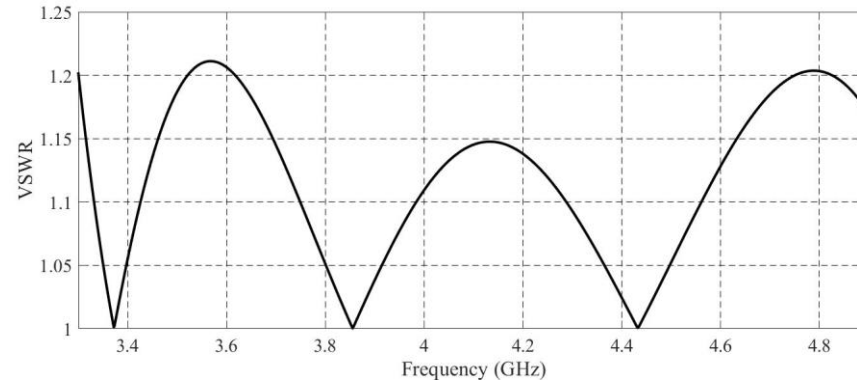
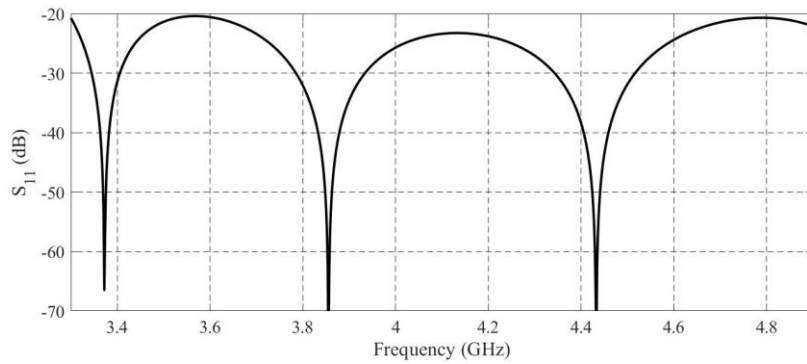

## Drawing

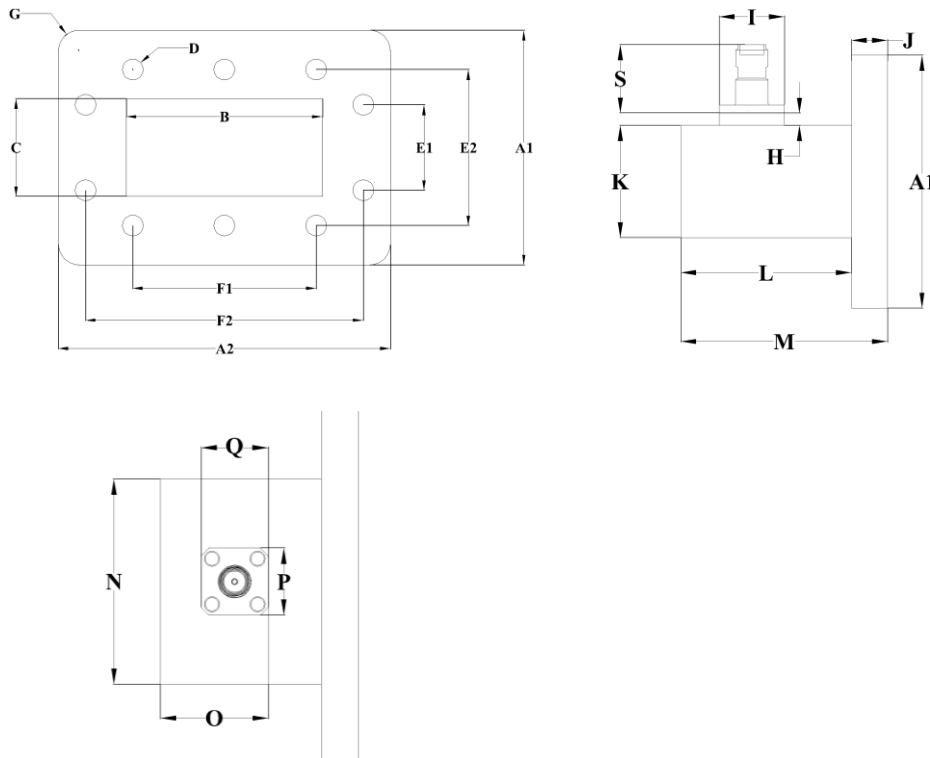

Parameter	Inch (mm)	Parameter	Inch (mm)
A1	2.752 (69.9)	M	2.270(57.661)
A2	3.874 (98.4)	N	2.256(64.17)
B	2.290 (58.17)	O	0.5(12.7)
C	1.145 (29.083)	P	0.5 (12.7)
D	0.25(6.35)	S	0.524(13.319)
E1	1 (25.4)		
E2	1.828 (46.44)		
F1	1.140 (54.36)		
F2	3.24(82.3)		
G	0.236(6)		
H	0.315(7.997)		
I	0.5 (12.7)		
J	0.315(8)		
K	1.381 (35.083)		
L	1.955 (49.661)		